

WE VALUE



YOUR HOME



Brinkinfield Road, Chalgrove
£425,000



Well-presented three-bedroom link-detached home, ideally situated in the village of Chalgrove.

The ground floor offers a generously sized lounge, featuring sliding doors that open directly onto an enclosed rear garden. The modern kitchen is thoughtfully designed and fitted with integrated Bosch appliances, providing both style and practicality.

Upstairs, the property boasts three well-proportioned bedrooms, all served by a contemporary family bathroom.

Externally, the home benefits from off-street parking for two vehicles along with a garage, offering excellent storage and convenience.

What the Owner Says...

"We love living in Chalgrove as there are so many local facilities for little ones, all within walking distance. The road is quiet and the neighbourhood is lovely. This has been a wonderful family home for us, and we hope someone else can create many more happy memories here."





- ENCLOSED REAR GARDEN
- THREE WELL-PROPORTIONED BEDROOMS
- MODERN KITCHEN WITH INTEGRATED BOSCH APPLIANCES
- WELL-PRESENTED THROUGHOUT
- GARAGE & OFF-STREET PARKING
- DESIRABLE VILLAGE LOCATION

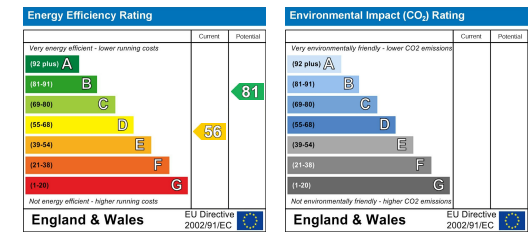

Energy Efficiency Graph

Floor Plan

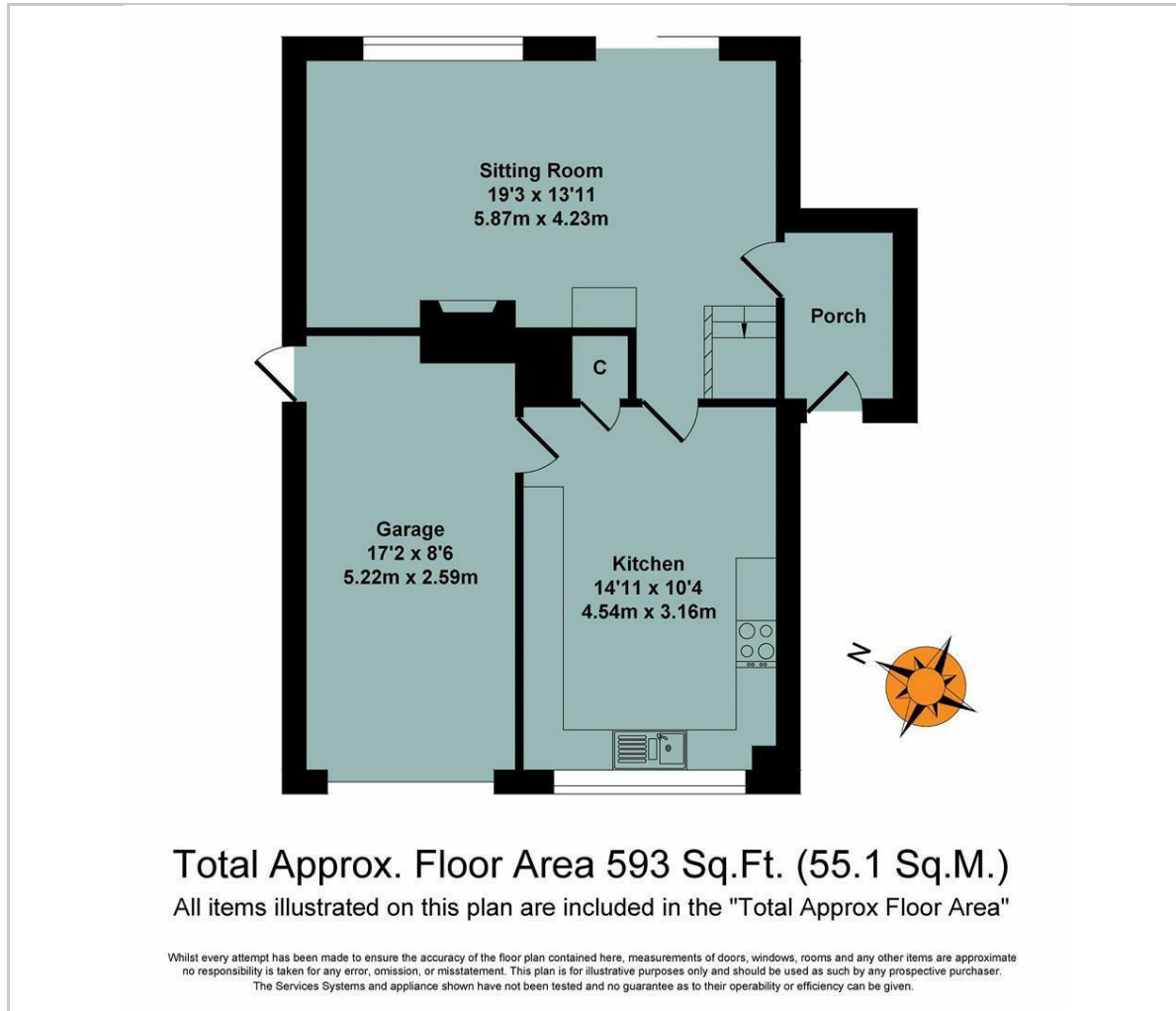

Area Map



Viewing

Please contact our In House Sales & Lettings Office on 01491 839999 opt.1 if you wish to arrange a viewing appointment for this property or require further information.

These particulars, whilst believed to be accurate are set out as a general outline only for guidance and do not constitute any part of an offer or contract. Intending purchasers should not rely on them as statements of representation of fact, but must satisfy themselves by inspection or otherwise as to their accuracy. No person in this firms employment has the authority to make or give any representation or warranty in respect of the property.

28 St Martins Street, Wallingford, Oxfordshire, OX10 0AL
Tel: 01491 839999 opt.1 Email: sales@inhouseestateagents.co.uk www.inhouseestateagents.co.uk